

A NOTE: SHEET JOINTS AROUND OPENINGS ARE GLUED or FOAM FUSED FOR STABILITY

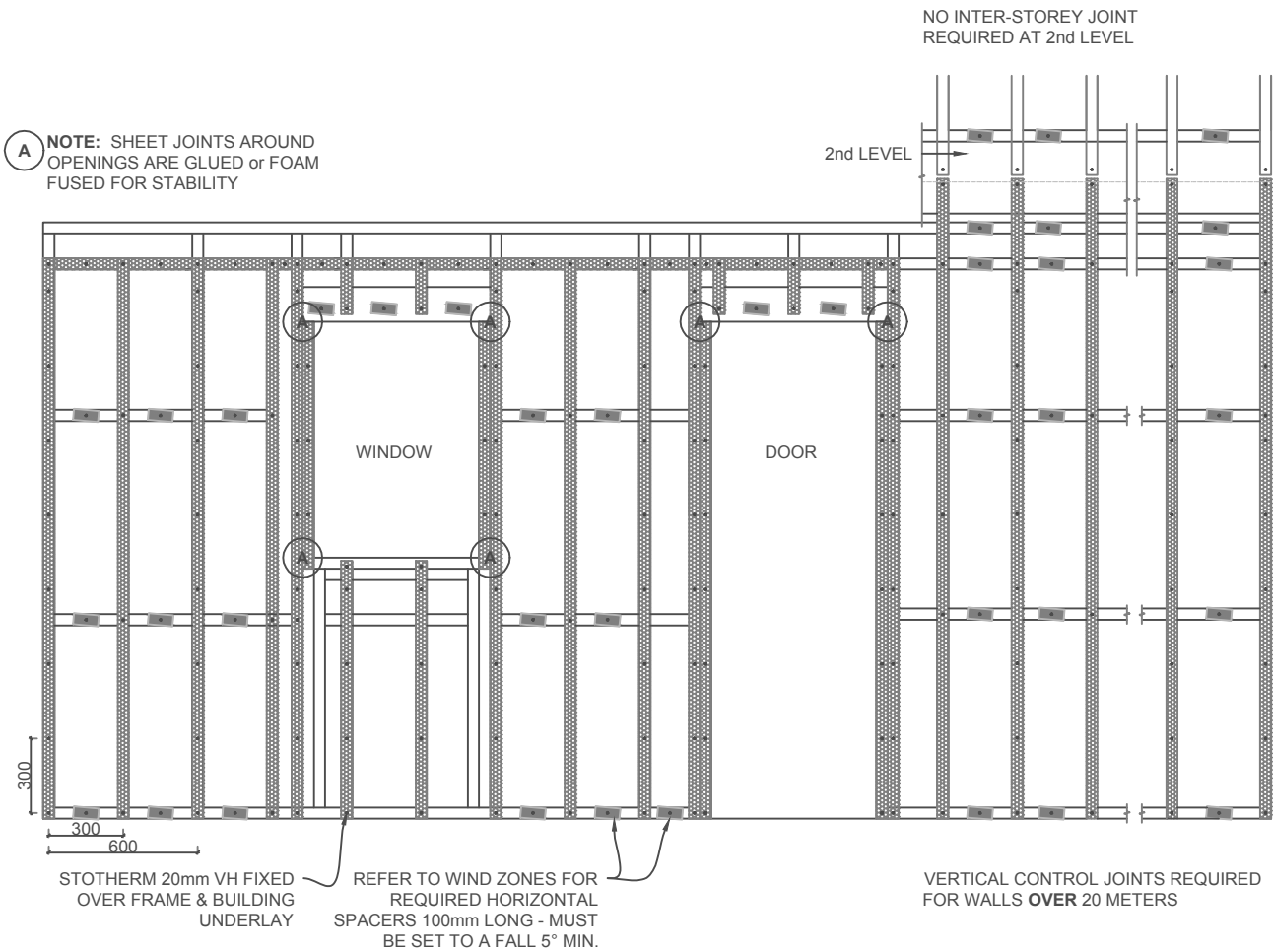

NOTE: CAVITY SYSTEM IS A VENTED DRAINAGE SYSTEM. FIX STO uPVC FOOT TRAY BEFORE BATTENS.

FIXINGS IN WIND ZONES

LOW, MEDIUM & HIGH
Studs 300mm fixing ctrs top & bottom plates and dwangs. One fixing between studs

VERY HIGH
Studs, plates and dwangs 200mm fixing ctrs
EXTRA HIGH
Studs, plates and dwangs 150mm fixing ctrs

WHERE STUD SPACINGS ARE GREATER THAN 450mm
CTRS FIX ADDITIONAL INTERMEDIATE BATTEN TO PREVENT INSULATION ENCROACHING INTO CAVITY SPACE

N.T.S

STOTHERM SYSTEM	STOTHERM INSULATED FACADE SYSTEM	ST 102
	EPS SHEET & FIXING LAYOUT - TYPICAL (Elevation)	2017