

ENSURE CONC.BLOCK WALLS ARE SUPPORTED DURING CONSTRUCTION
45mm MIN.REBATE IS RECOMMENDED

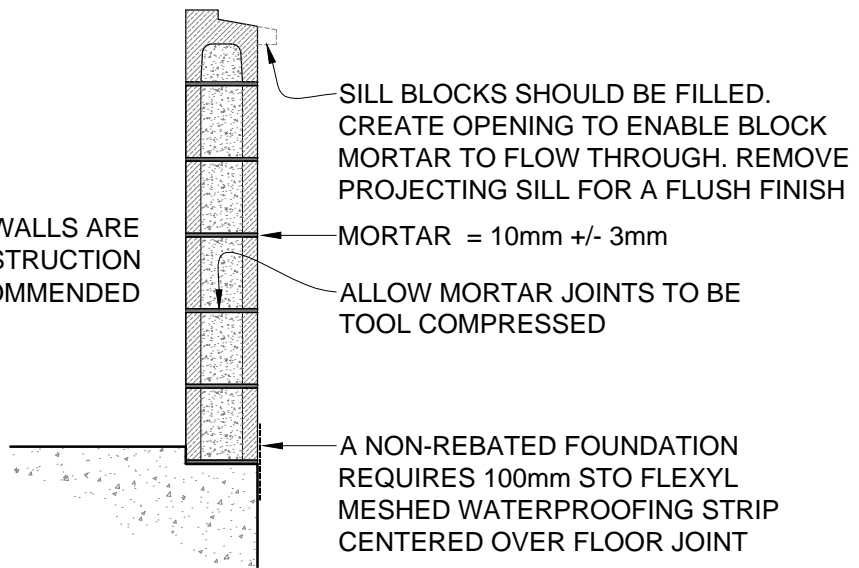

NOTE:

1. MAIN CONTRACTOR IS TO ENSURE SEPARATE WALLS, STAIRS or DISSIMILAR MATERIAL AGAINST BLOCKWORK ARE WATERPROOFED AS NECESSARY TO FORM A **WATERTIGHT** CONNECTION WITH THE **STO PLASTER SYSTEM**
2. IT IS CRITICAL IN PARTIALLY FILLED BLOCKS THAT JOINTS ARE TOOLED FOR **EARTHQUAKE** RESISTANCE
3. MASONRY CONCRETE BLOCKS as per NZS4210 / 4229 & 4230 or SPECIFIC ENGINEER DESIGN
4. ALLOW ADEQUATE TIME FOR BLOCKS TO DRY/STABILISE BEFORE PLASTERING. IN **NORMAL DRYING** CONDITIONS 4-8 WEEKS
5. CONTROL JOINTS - REFER ENGINEERS SPECIFICATION, BLOCK MANUFACTURERS RECOMMENDATION or NZS4229

SCALE 1:20

STO CONCRETE BLOCK	STO CONCRETE BLOCK	CB 003
	CONSTRUCTION & DETAILING	2014