

OR

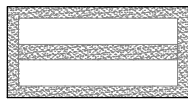

STOTHERM PANELS
1200x600mm STO ADHESIVE
MORTAR WITH 100mm
PERIMETER BAND & 100mm
BANDS

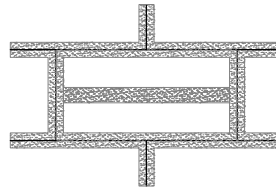

STOTHERM PANELS
1200x600mm STO ADHESIVE
MORTAR NOTCH TOWELED
ON CONCRETE BLOCKS

NOTE: PANELS TO BE STRETCHER BOND STARTING FROM BOTTOM AND STO ADHESIVE MORTAR & MECHANICALLY FIXED WITH STOTHERM ANCHORS. ALL PANEL CUTS SHALL BE MADE CAREFULLY TO ACHIEVE A *BUTT* FIT. ADHESIVE FOAM ANY GAPS AFTER FIXING.

STO CONCRETE BLOCK	STO CONCRETE BLOCK INSULATION SYSTEM	STCB 102
	STOTHERM PANEL & ANCHOR LAYOUT	2014