



**StoStucco Render Systems**  
Following the frame straight  
curved and round construction

# StoStucco Render System

## Unlimited design possibilities

Stucco, an outstanding solution with a reinforced backing, dates back to pre-biblical times using saplings and an application of clay renders to decorate and protect buildings.

Embracing this concept by using the latest technology and European components, Sto has released StoStucco, a render system on a rigid stainless steel lath. This compliant system meets the requirements of the New Zealand Building Code. Following traditional practices the StoStucco Render System is a guaranteed solution to cover timber framed construction and allow the designer an opportunity to bend the rules when designing residential or commercial property.

**Cover: Shelly Bay Residence, Auckland  
Architect: Andrew Mirams Architecture**

**Right: Chancery Square, Auckland  
Architect: Ignite Architects**



CHANCER

Chancer So. I.

Chancer So. I.  
YOU'RE WELCOME

# StoStucco Facades

Easier application – high efficiency and reliability

**StoStucco is a BRANZ appraised render system based on the traditional New Zealand stucco net system. It is cost-effective, highly flexible, durable and crack resistant . With simple installation and easy assembly, it far outways any conventional stucco system.**

The system Incorporates a lath made from a stainless steel welded wire mesh and can be moulded to suit the shape and curvature in buildings, creating unlimited design possibilities.

This is combined with a lightweight engineered mineral basecoat and technologically advanced fibre reinforcement render system and finish. StoStucco is superior to the traditional, hand mixed applicator product and comes with a StoWarranty.

## Benefits at a Glance

- Saves Time and Cost
- Unlimited design possibilities due to the flexible lath
- Cement-free reinforcing compound / base coat with guiding grain
- Flexible and crack-proof
- High durability and impact resistance
- Highly resistant to mechanical stress
- Ready-to-use
- Range of Finishes
- Weathertight
- Faceload tested to 6.5 kPa
- Seismic Racking Test
- ISO 5660 fire tested
- Wind Pressure to 4.9 kPa 69m/sec
- Residential & Commercial applications



## StoArmat Reinforcement Render

An organic, cement-free reinforcing compound StoArmat with guiding grain has evolved over 50 years with a successful global history covering 100 million metres plus. The flexible properties, application reliability and security of a twenty year warranty has ensured StoArmat Classic has become a bench mark in the New Zealand market.



Below: Mon Desir Apartments, North Shore



### Weathertight

The StoStucco Render System incorporates a first and second line of defence against water penetration by separating the cladding from the external wall framing and then providing a min 3mm of synthetic waterproof render and finishing coats which protect against moisture, dirt and environmental forces.

### Save Time and Costs

StoStucco's time and cost efficiency results not only from the quick and easy installation of the lath; Using a PFT Ritmo mixing pump the Sto System can be applied in a fraction of the usual application time.



A bend test demonstrating the extraordinary elasticity and resultant high crack resistance of Sto synthetic renders.

# StoStucco Render System

A traditional method embracing the latest technology

**A functioning system is based on the optimum performance of its separate components. Over 40 years of fine-tuning and the ongoing development of the components have contributed to constant improvements.**

**StoStucco Render System** - Incorporates a European lath made from a stainless steel welded wire mesh with an absorbent sheet of perforated chip paper, and fixed over timber battens to form the cavity. The perforations in the chip paper allow an optimal key of the lightweight mineral basecoat to sit around the stainless steel wires, providing a thick solid render base. The uPVC flashings lock into the junctions and joinery providing a neat junction ready for a weathertight sealant.

As additional reinforcement, StoArmat meshed reinforcement render is applied over the basecoat. StoArmat is a cement-free, ready-to-use, flexible render, providing maximum crack and shock resistance. The Glass fibre mesh is an alkali-resistant reinforcing mesh with total uniform force absorption and it reliably dissipates tensile and shear stress.

Installations are carried out by a Sto Registered Licensed Building Practitioner with the added protection of a StoArmat 15 or 20+ Year Warranty and StoService Assurance, guaranteeing building code compliant materials are used and application meets building code standards, including a service plan for long-term security.

**Right: Stucco re-clad, Wellington**  
**Right below: Fixing detail**

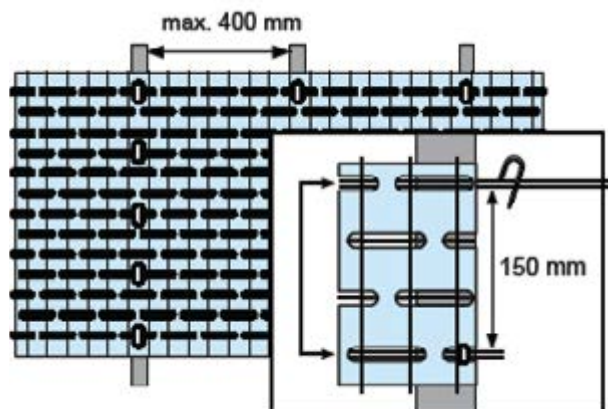



**BRANZ Appraised**  
BRANZ appraisal no. 605



**StoArmat 20+ Year Warranty**  
with StoService Assurance

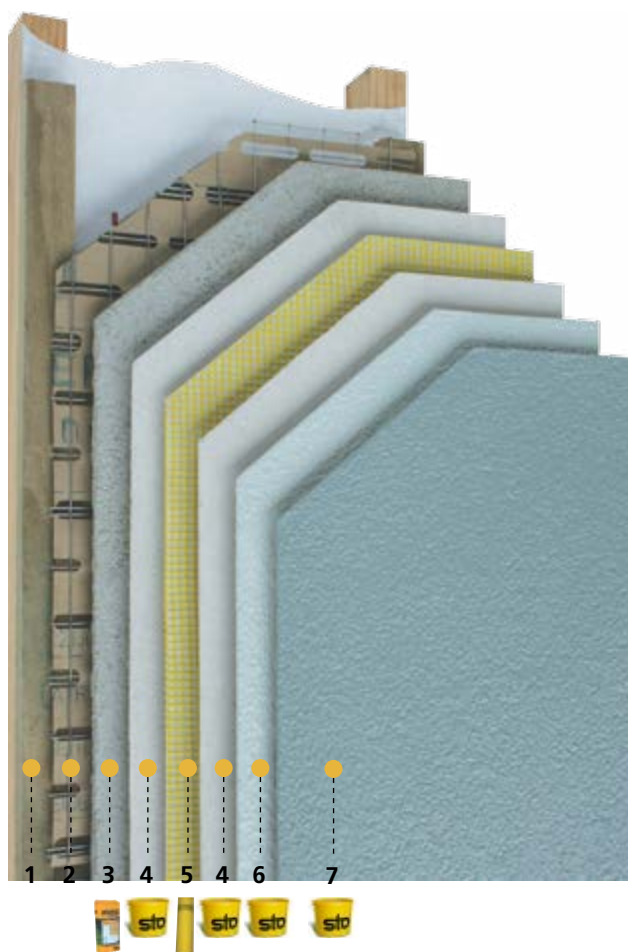

### Perfect Interaction

- 1. Timber Battens**  
25 mm x 45 mm timber cavity battens.
- 2. Substrate: Stainless Steel Lath**  
European manufactured and certified lath, which is light and strong, easy to shape and to install. Includes uPVC flashings for joinery, junctions and terminations.
- 3. Basecoat: LevelLite Mineral Render**  
Lightweight EPS bead mineral plaster with good build properties, water retention agents and machine application properties.
- 4. Reinforcement Render: StoArmat**  
Organic, flexible, crack-resistance render to combat stress and seismic activity.
- 5. Mesh: StoMesh**  
Easy-to-install European mesh meets the highest requirements for crack, stress and alkalinity resistance.
- 6. Coloured Finishing Renders: Stolit Range**  
Organically bound, strong, hard-wearing, impact-resistant, pre-coloured finishing renders.
- 6. Facade Paint: StoColor**  
StoColor coating based on IQ Net Technology for functional facades.

For more information and CAD details  
please visit: [www.sto.co.nz](http://www.sto.co.nz)

# Stolit: Coloured finishing renders

Providing your facade with optimum protection

**Stolit organic finishing renders are manufactured in Germany incorporating the latest technology; certified globally and successfully applied to rendered substrates in every climatic zone for over 50 years.**

The Stolit range provides the perfect combination of properties: durable, strong, hard-wearing, impact-resistant, malleable, weather-resistant, colour-stable and highly resistant to microorganisms. In addition, its vapour permeability allows your building to breathe while still repelling water.

Whichever finishing render is chosen, each one is part of a tested and approved system, providing optimum protection and durability; This makes it indispensable in today's construction industry.

## Benefits at a glance

- Available in the full spectrum of colours.
- Extremely low water absorption.
- Optimum surface adhesion.
- Shock-proof and highly resistant to cracking.
- Exceptional resistance to mechanical stress.
- Outstanding colour stability and product stability process – does not require an equalisation coat.
- Excellent application properties.



Stolit MP



Stolit MP Natural







All Stolit renders are easy to apply and can be tinted using the StoColor System or matched to the colour of your choice using the Sto Spectrometer.



Stolit K 1.0mm



Stolit K 1.5mm



Stolit K 2.0mm



Stolit K 3.0mm

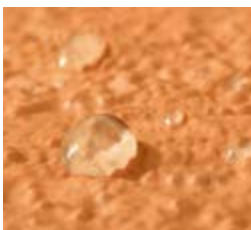

Stolit renders are polymeric, allowing them to repel water and breathe, providing long-term protection superior to traditional, painted plaster systems.



Stolit Milano

# The perfect finish

Facades as individual as you and your project

The StoColor finish, a serviceable coating embodying intelligent technology for a range of surface functions to complement the architectural structure and design. The StoColor System, with 800 shades or matched to any colour using the Sto Spectrometer, provides a clear framework and systematic approach to colour based on integrated layers, combining texture and colour for aesthetic appeal.

## Tested protection and quality

Sto paints establish easy-to-maintain surfaces and an outer layer of the Sto protection system, fulfilling all-important physical building requirements in terms of serviceability and functionality. StoColor facade paint is based on Sto intelligent technology, inspiring an innovative range of surface functions.



Sto has been conducting intensive research in the field of bionics for many years. The result: facade paint with iQ – Intelligent Technology where innovative surface functions provide clear added value.

New StoColor X-black	StoColor Lotusan®	StoColor Maxicryl	StoColor Lastic Satin
<p>Strong colours for cool facades. A facade paint with X-black technology for dark-coloured facades.</p>	<p>Dirt runs off with the rain. A tried-and-tested facade paint with patented Lotus-Effect® technology for facades that stay cleaner for longer.</p>	<p>A natural looking, matt acrylate facade dispersion paint with high covering power and colour fastness. Suitable for masonry, brick, precast and all Sto rendered substrates.</p>	<p>Durable elastomeric facade paint that bridges cracks in the underlying substrate, for a waterproof solution.</p>
<p>At a glance:</p> <ul style="list-style-type: none"> <li>• Reflects the near-infrared spectral region of solar energy.</li> <li>• Wide variety of colours and shades, a high level of colour stability.</li> <li>• Especially suited to dark colour shades.</li> <li>• Natural matt finish.</li> </ul> 	<p>At a glance:</p> <ul style="list-style-type: none"> <li>• Maximum resistance to atmospheric soiling.</li> <li>• Natural protection against algae and fungal attack.</li> <li>• Full colour selection.</li> <li>• Lotusan® is available with additional film protection.</li> <li>• Natural matt finish.</li> </ul> 	<p>At a glance:</p> <ul style="list-style-type: none"> <li>• Excellent hiding power.</li> <li>• Full colour selection.</li> <li>• Easy, simple application.</li> <li>• Natural matt finish.</li> </ul>	<p>At a glance:</p> <ul style="list-style-type: none"> <li>• Elastomeric dispersion paint.</li> <li>• Water-vapour permeable.</li> <li>• Excellent hiding power.</li> <li>• Ideal refurbishment coating.</li> <li>• Good colour selection.</li> <li>• Low-sheen satin finish.</li> </ul>

# Well advised

Let yourself be inspired

**Individual customer consultation and project support is the basis of a successful business relationship at Sto. Whether on the telephone, in the sales centre or on the construction site – the Sto team are pleased to provide you with advice, assistance and creative ideas.**

### Sto customer service

Service at Sto goes far beyond the development and sale of high-quality products. Ultimately, any product is only as good as its application. This is why Sto places great emphasis on service and consultation. The Sto team are focused on their customers, providing comprehensive information and tips on the practical use of new products and relaying detailed knowledge from the Sto technical department.

### Smart and sustainable

Sto's impact on performance is big, but the footprint on the environment is small. All Sto products are vapour permeable, easy to apply, safe and non-toxic with low VOCs. Sto incorporates sustainable practices throughout its operations, earning ISO 9001 for quality assurance and 14001 certification for its environmental management system. Many Sto products help reduce the environmental impact of construction by providing insulation, reducing maintenance requirements and extending the life cycle of building facades.

**For contact details of your nearest Consultant, please see the reverse side of this brochure.**



BRANZ Appraised



QUALITY ASSURED



EN ISO 14001

**Head Office**

**Wellington**

Stoanz Ltd  
72 Abel Smith Street  
Wellington, New Zealand  
Phone +64 4 801 7794  
Fax +64 4 384 9828

**General Enquires**

Phone +64 4 801 7794  
info@sto.co.nz  
www.sto.co.nz



**New Zealand Offices**

**Auckland**

1 George Street, Mount Eden  
Auckland, New Zealand  
Phone +64 9 522 1058  
Fax +64 9 522 1054

**Tauranga**

Phone +64 4 801 7794  
Mobile +64 27 299 9290

**Christchurch**

47A Waterloo Road, Hornby  
Christchurch, New Zealand  
Phone +64 3 338 3570  
Fax +64 3 338 3571

**Queenstown / Wanaka**

Phone +64 4 801 7794  
Mobile +64 27 453 3240

**Australian Office**

**Sydney**

Stoanz Australia Ltd  
7 Mitchell Street, Marrickville  
Sydney, NSW, Australia  
Phone +61 2 9560 9589  
Fax +61 2 9572 6003  
info@stoau.com.au  
www.stoau.com.au