

**STOARMAT CONSTRUCTION SYSTEM**

1. KEEP SHEETS DRY BEFORE USING.
2. READ SPECIFICATIONS AND CHECK DRAWINGS, DETAILS, FRAMING, UNDERLAY, FLASHING TAPES, AND BLOCKING IS SATISFACTORY
3. INSTALL STO PVC TRAY AND JOINERY FLASHING AS PER STO DETAILS (*BUILDER TO SUPPLY ALUMINUM HEAD FLASHING WITH STOPENDS*)
4. CHECK LAYOUT AND INSTALL SHEETS VERTICALLY STARTING FROM BOTTOM PLATE
5. STAGGER VERTICAL SHEET JOINTS TO AVOID CONTINUOUS JOINS
6. SECURE SHEETS WITH FIXINGS AS PER MANUFACTURER DETAILS
7. MEASURE DISTANCES ACCURATELY TO AVOID NARROW IN FILLS OR GAPS

**SAFE WORKING PRACTICE**

1. HAVE SUFFICIENT PEOPLE TO LIFT SHEETS ON SITE
2. WEAR PROTECTIVE CLOTHING, EYE AND EAR PROTECTION AND DUST MASK OR RESPIRATOR WHEN CUTTING OR SANDING
3. USE A CIRCULAR SAW FITTED WITH A DIAMOND BLADE OR F/C SCRIBER AND HEPA VACUUM WHEN CUTTING
4. CONTAIN CUTTING AREA TO MINIMIZE DUST - HEPA VACUUM UP RESIDUE
5. PROVIDE SUITABLE ACCESS PLATFORMS, EQUIPMENT AND TOOLS TO CARRY OUT THE WORK
6. COMPLY WITH HEALTH AND SAFETY REGULATIONS AND MAINTAIN FIRST AID EQUIPMENT AS PER THE LEGISLATION

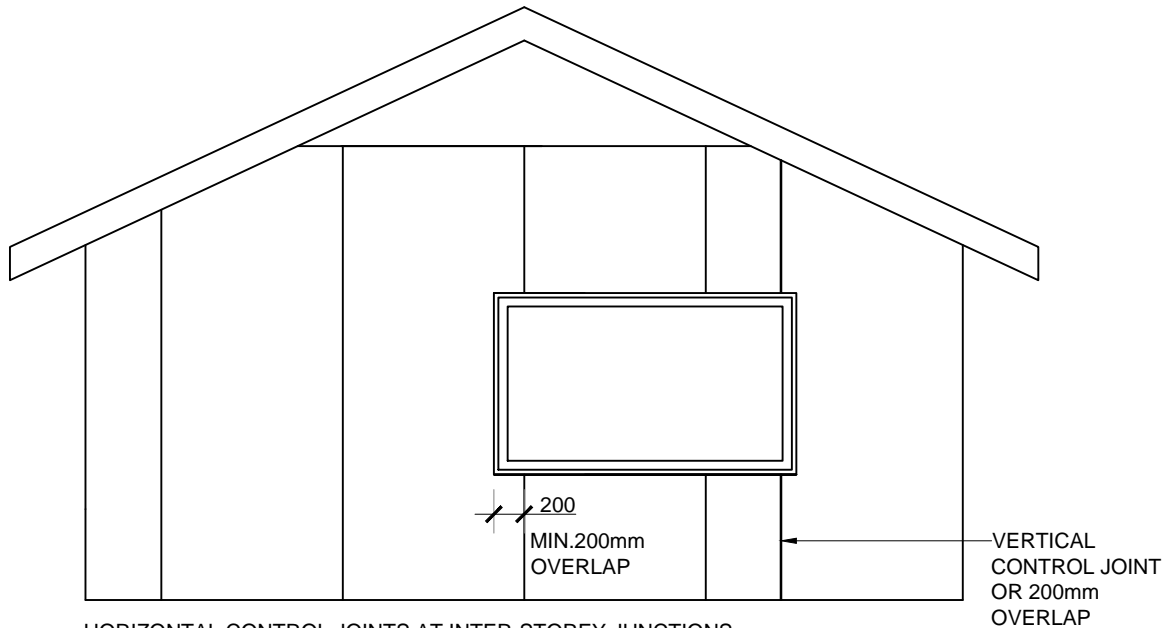

HORIZONTAL CONTROL JOINTS AT INTER-STOREY JUNCTIONS  
**OR AT 5400mm MAX. ON CONTINUOUS STUDS**

VERTICAL CONTROL JOINTS - 5400mm MAX.CTRS **OR AT**  
 DISSIMILAR MATERIAL

SCALE 1:50

<b>STO/ MONOTEK</b>	<b>STOARMAT CONSTRUCTION SYSTEM</b>	<b>MFCS 007</b>
	<b>SHEET LAYOUT</b>	<b>2014</b>

The information contained in this detail is based on our experience and testing and represents the latest information available at the date of issue. This detail is intended for use by the design professional and users of Sto products to assist in developing specific project details to be used in conjunction with a Sto Specification. We reserve the right to alter or update information at any time without prior notice & it is the responsibility of the specifier and/or the project manager to insure that they have the current Sto details and specifications.