

STOPPOREN FACADE	STOPPOREN FACADE SYSTEM	PP 830
	EXT. CNR CONC. BLOCK/STOPPOREN	2018

The information contained on this page is based on our experience and research at the date of issue. The detail is for use by Registered Architects, Licensed Designers or Chartered Engineers to assist in developing project details using Sto Systems. Stoanz Ltd reserve the right to alter or update information at any time without prior notice and it is the responsibility of the designer, project manager or Sto contractor to insure they have and use the current Sto details and specifications on site.

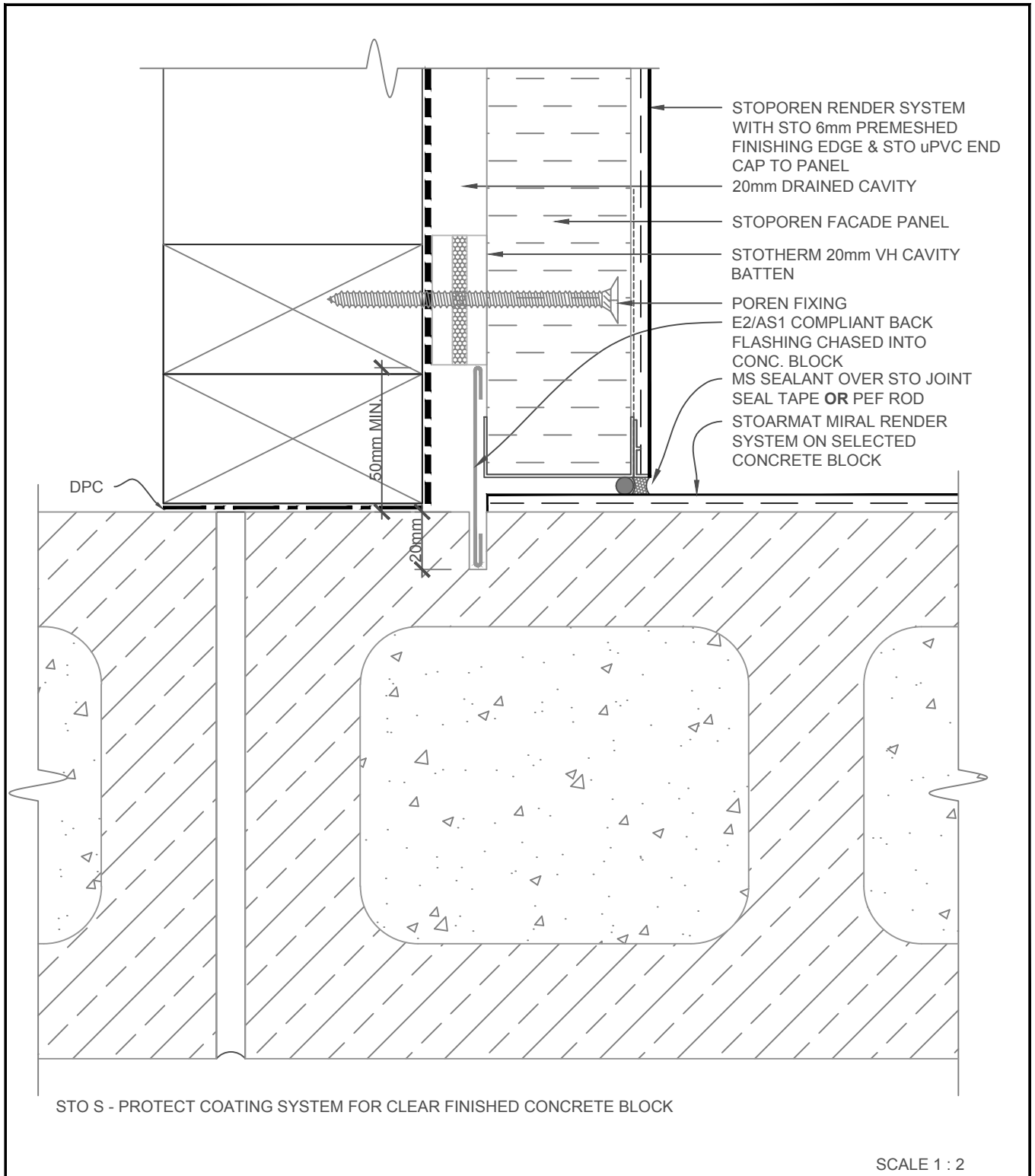

STOPOREN FACADE	STOPOREN FACADE SYSTEM	PP 831
	INTERNAL CORNER CONC. BLOCK/STOPOREN	2018

The information contained on this page is based on our experience and research at the date of issue. The detail is for use by Registered Architects, Licensed Designers or Chartered Engineers to assist in developing project details using Sto Systems. Stoanz Ltd reserve the right to alter or update information at any time without prior notice and it is the responsibility of the designer, project manager or Sto contractor to insure they have and use the current Sto details and specifications on site.

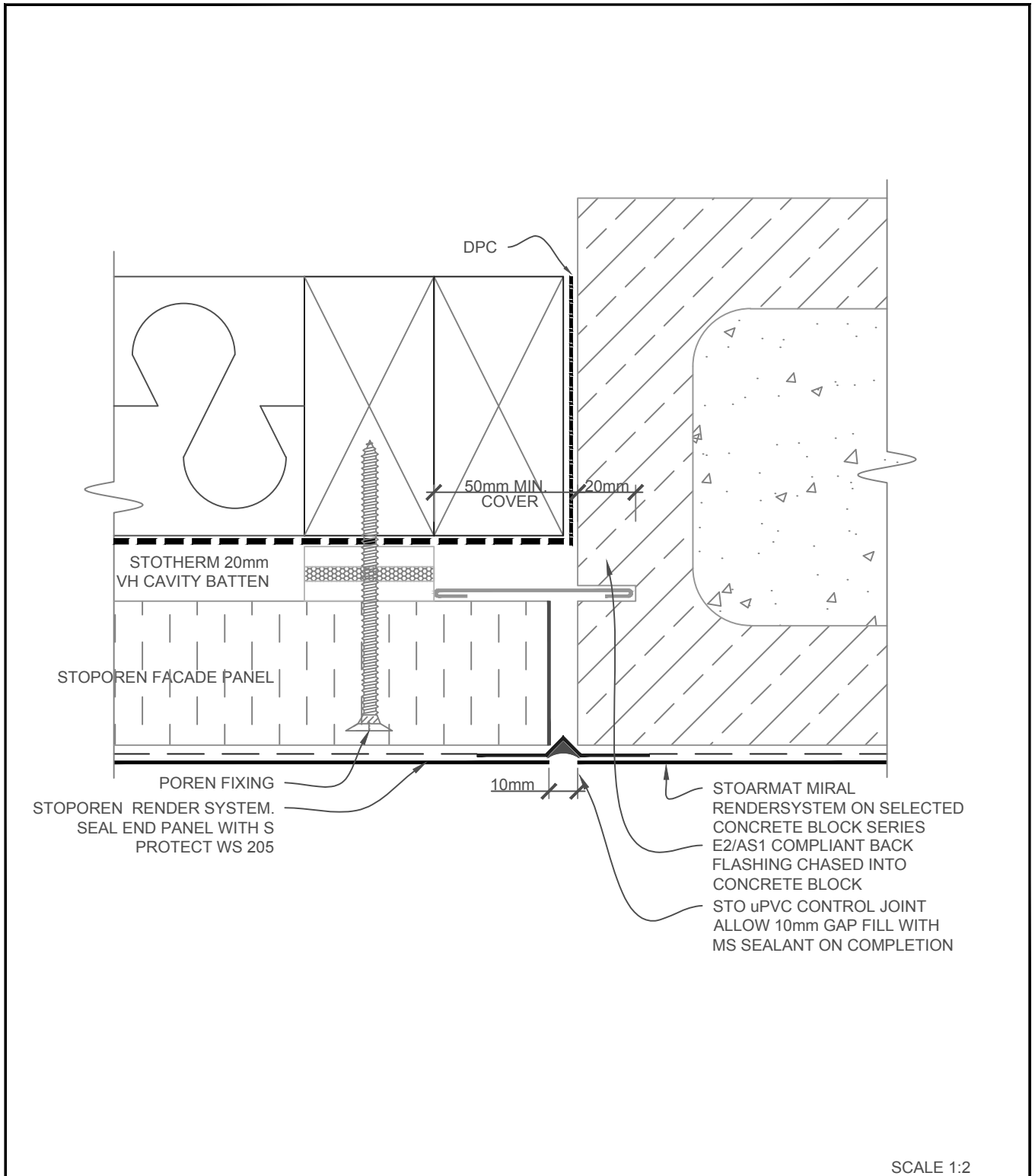

SCALE 1:2

STOPOREN FACADE	STOPOREN FACADE SYSTEM	PP 832
	VERTICAL JOINT CONC. BLOCK/STOPOREN	2018

The information contained on this page is based on our experience and research at the date of issue. The detail is for use by Registered Architects, Licensed Designers or Chartered Engineers to assist in developing project details using Sto Systems. Stoanz Ltd reserve the right to alter or update information at any time without prior notice and it is the responsibility of the designer, project manager or Sto contractor to insure they have and use the current Sto details and specifications on site.

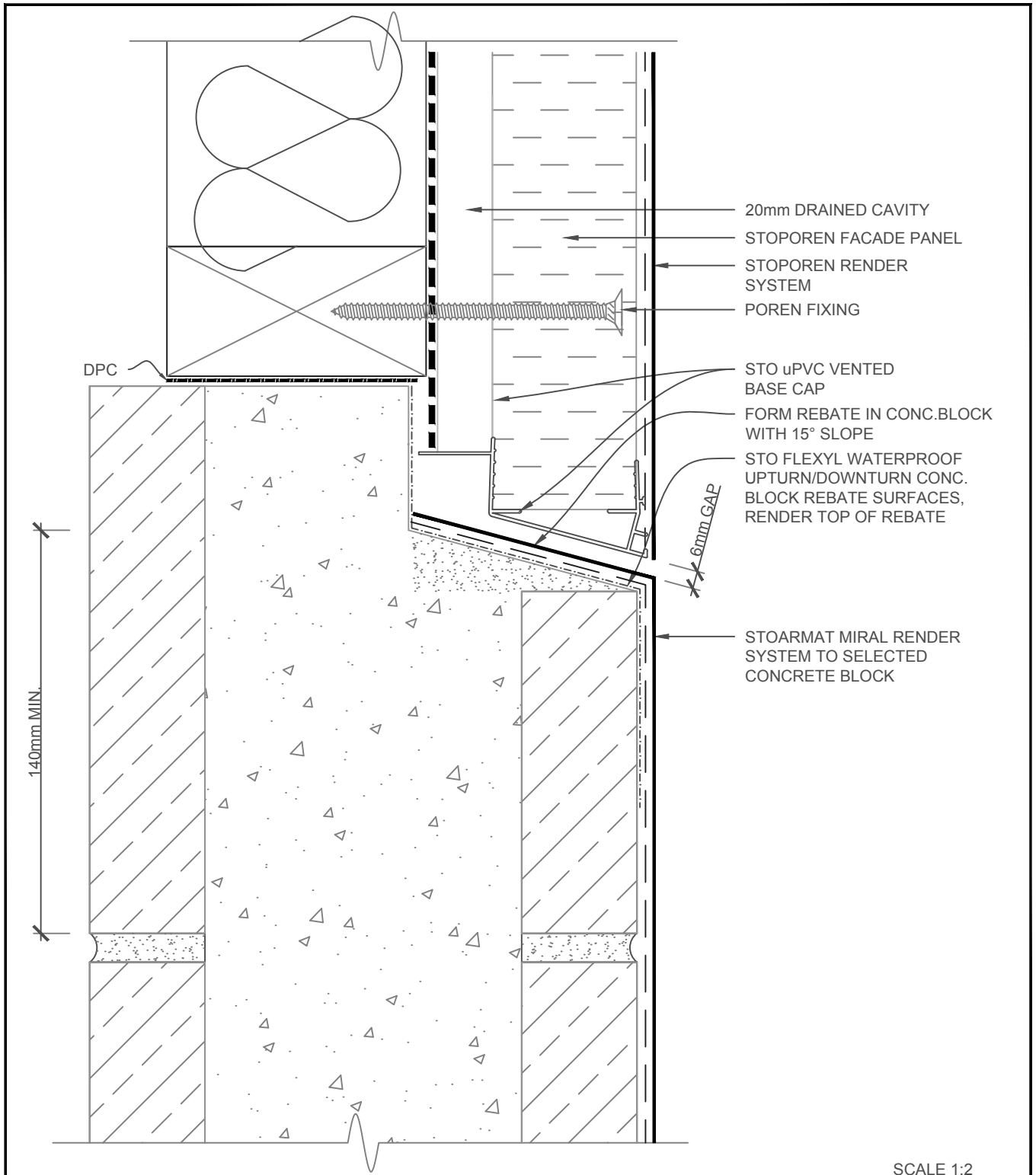

SCALE 1:2

STOPOREN FACADE	STOPOREN FACADE SYSTEM	PP 833
	HORIZONTAL JUNCTION CONC. BLOCK/STOPOREN	2018

The information contained on this page is based on our experience and research at the date of issue. The detail is for use by Registered Architects, Licensed Designers or Chartered Engineers to assist in developing project details using Sto Systems. Stoanz Ltd reserve the right to alter or update information at any time without prior notice and it is the responsibility of the designer, project manager or Sto contractor to insure they have and use the current Sto details and specifications on site.