

1. EXISTING EXTERIOR CHECK:
 - CHECK JOINERY REBATES FOR CRACKS ESPECIALLY SILL BLOCKS
 - CHECK GROUND FLOOR / BLOCK JOINTING FOR FRACTURES
 - CHECK AREAS ADJACENT OR OVER BLOCKS ARE WATERTIGHT - SOFFITS, PORCHES, ETC.
 - CONTROL JOINTS ARE REQUIRED VERTICALLY EVERY 6 LINEAR METRES OR AS PER THE ENGINEERES OR MANUFACTURERS DRAWINGS
2. EXISTING ALUMINIUM JOINERY CHECK:
 - CHECK JOINERY MITRES FOR LEAKS AND RESEAL AS REQUIRED, TO BE CARRIED OUT BY JOINERY INSTALLER
 - CHECK CONCRETE BLOCK REBATES HAVE BEEN USED
 - CHECK CONCRETE BLOCK REBATES HAVE BEEN WATERPROOFED
 - CHECK WINDOW PERIMETER HAS A SEALANT BEAD - SILLS CAN HAVE 5 MM GAP
 - NOTE: IF JOINERY HAS BEEN INSTALLED ON TIMBER REBATES CHECK WATERPROOFING DETAILS
3. APPLICATION - SS202R STOARMAT REMEDIAL PLASTER SYSTEM:
 - a. STOLASTIC FILL/STO RF MESH CRACK ADDRESSMENT
 - b. IF REQUIRED LEVLLITE BASECOAT PLASTER TO LEVEL TEXTURE
 - c. STOARMAT MESHED REINFORCEMENT PLASTER
 - d. STOLIT K COLORED FINISHING RENDER
 - e. STOCOLOR MAXICRYL OR STOLASTIC COLOR FACADE PAINT (STO FLEXYL WATERPROOFING TO JOINERY REBATES IF REQUIRED)

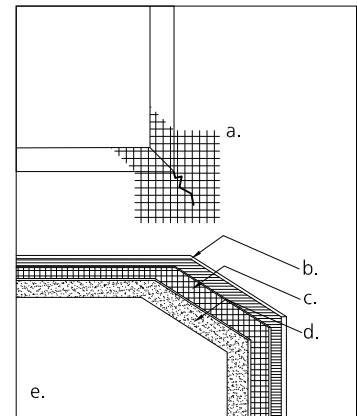

REMEDIAL PLASTER SYSTEM	SS202R - STOARMAT REMEDIAL PLASTER SYSTEM	SAR-101
	OVER CONCRETE BLOCK CONSTRUCTION	JULY 2010

The information contained in this detail is based on our experience and testing and represents the latest information available at the date of issue. This detail is intended for use by the design professional and users of Sto products to assist in developing specific project details to be used in conjunction with a Sto Specification. We reserve the right to alter or update information at any time without prior notice & it is the responsibility of the specifier and/or the project manager to insure that they have the current Sto details and specifications.